

19 Bondell Avenue Gymea, NSW



5



3



2

## The Ultimate - North Facing, Family Entertainer

Enjoy Sunday BBQ's on the north facing entertainers decking?  
Spend summer swimming in the glistening in-ground pool?  
Walk up to Gymea Village and enjoy the restaurants and cafes?  
This is the one you have been waiting for...

This recently renovated, private family residence showcases large open plan living with an abundance of natural light and generous proportions. Perfect for a family of any size and offering a huge chefs' kitchen, with a large island bench, opening to the covered entertaining and overlooking the glistening in-ground pool & lawns.

Features include;

- Stone kitchen with breakfast bar looks out over the rear yard and pool.



**Matthew Callaghan**

0411525606

# 19 Bondell Avenue, Gymea

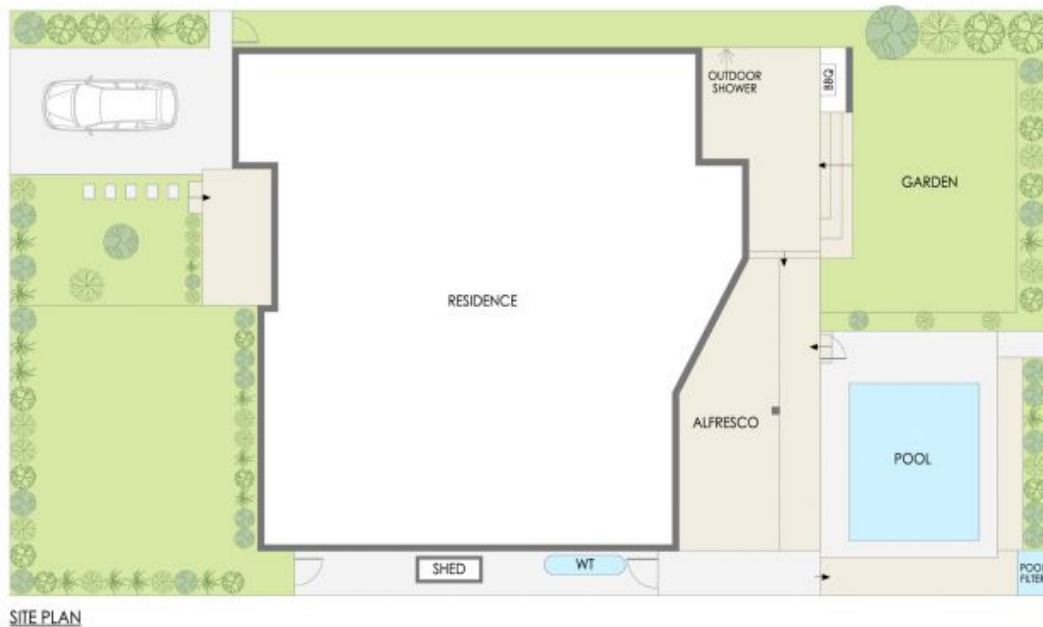
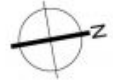

PLANS SHOWN ONLY INDICATIVE OF LAYOUT. DIMENSIONS ARE APPROXIMATE.

19 Bondell Avenue Gymea, NSW