



6/72-74 Talara Road Gymea, NSW



2



1



2

Tranquil Ground Floor Apartment with Leafy Outlook

Relax and unwind on your balcony, soaking in the peaceful leafy outlook...
Walk up to Gymea Village where you can hop on the train for an easy commute into the city...

Treat yourself to breakfast at Hazelhurst Art Gallery with its beautiful fenced grounds...

This is the one you've been waiting for..

Features include;

- Large, air-conditioned open plan living & dining that flows to the balcony
- Modern bathroom with separate shower and bath.
- Well appointed stone kitchen with stainless steel appliances, dishwasher



Matthew Callaghan Lachlan McGrath

0411525606

0475222600

6/72 Talara Road, Gymea

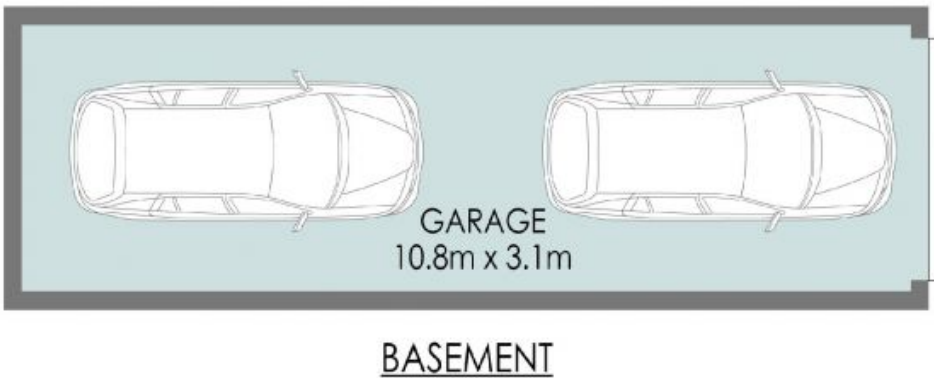
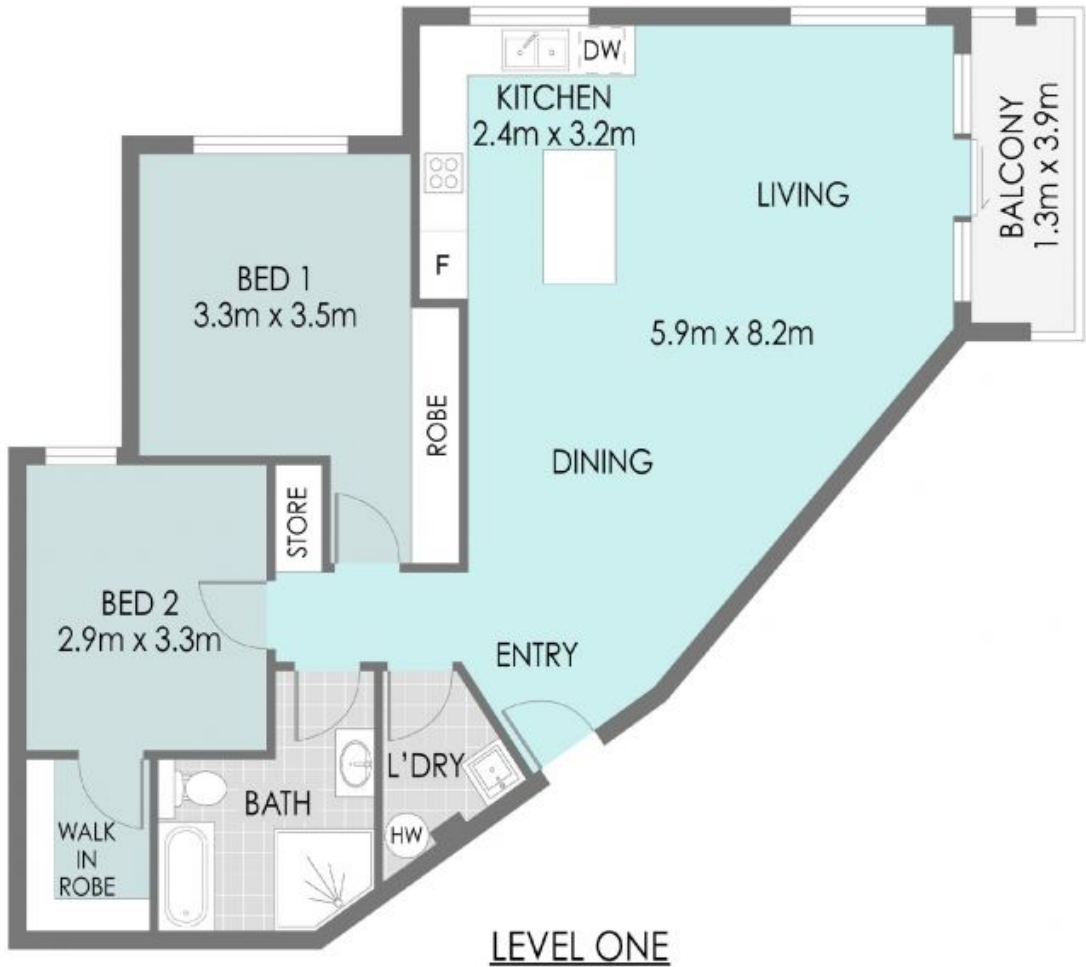

PLANS SHOWN ONLY INDICATIVE OF LAYOUT. DIMENSIONS ARE APPROXIMATE.
Measurements are approximate and not to scale. The vendor, agency and supplier will accept no liability for its accuracy.
Interested parties are advised to make their own independent enquiries.



MATTCALLAGHAN
PROPERTY



MATTCALLAGHAN
PROPERTY

6/72-74 Talara Road

Gymea, NSW